



# HORA

---

eTec

## Technical data sheet SSAK-series



## Technical data

Description:	Busbar Tapping 10mm <sup>2</sup>
Construction:	uninsulated
Item no. :	086005-9-2

Remarks:	The product is compliant with the EC ROHS directives
Standards:	-
Nominal Voltage:	690 V
Nominal current:	82 A

### Busbar cross section / Incoming

1 x Busbar	Cu Stärke (Höhe) 3 – 10 mm / Tiefe (Breite) mindestens 10 mm
	Clamping screw for busbar connection:
	cross-head screw M5 x 12 +/- PZ2
	tightening torque 2 Nm

### Terminal cross section / Outgoing

2 x 10 mm <sup>2</sup>	1,5 – 10 mm <sup>2</sup> , round conductor Cu (solid wire and multi wire)
	1,5 – 6 mm <sup>2</sup> , stranded wire with ferrule
	cross-head screw M4 x 8 +/- PZ2
	tightening torque 1,2 Nm
	stripping length -

Materials:	Terminal body: brass (CuZn39Pb2) bright
	Screws: steel Zn thick-film passivated

Mechanical data:	Dimensions: width x height x depth (mm): 9 x 35,6 x 23,6
------------------	--

mounted dimensions (5 mm bar)

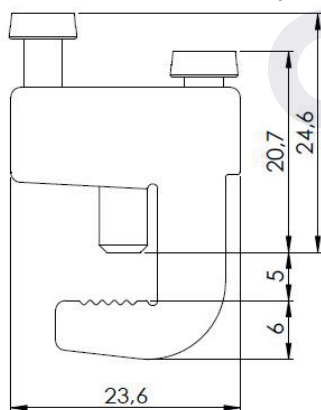

mounted dimensions (10 mm bar)

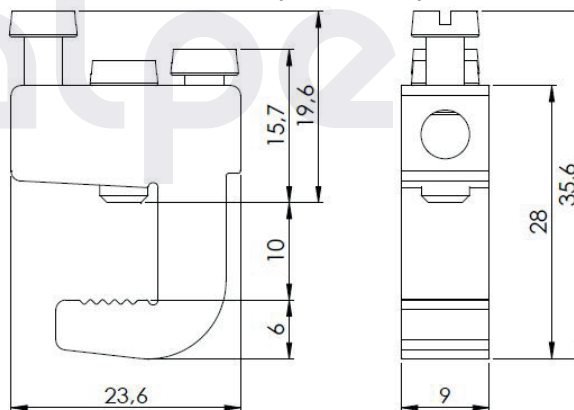

### Design

Basic housing colour – light grey RAL 7035

Part no.	Design	Cover colour	PU	GTIN (EAN)
086005-9-2	Universal	-	12	4051589600590



**Technical data**

Description:	Busbar Tapping 16mm <sup>2</sup>
Construction:	fingersafe
Item no. :	086105...

Remarks:	The product is compliant with the EC ROHS directives
Standards:	DIN EN 60947-7-1
Nominal Voltage:	690 V
Nominal current:	114 A - (Details see below)

**Busbar cross section / Incoming**

1 x Busbar	Cu busbar strength (height) 3 – 10 mm / depth (width) minimum 10 mm Clamping screw for busbar connection: cross-head screw M8 x 20 +/- PZ3 tightening torque 3 Nm
------------	--

**Terminal cross section / Outgoing**

2 x 16 mm <sup>2</sup>	1,5 – 16 mm <sup>2</sup> , round conductor Cu (solid wire and multi wire) 1 – 10 mm <sup>2</sup> , stranded wire with ferrule cross-head screw M6 x 10 +/- PZ2 tightening torque 2,5 Nm stripping length 12 mm
------------------------	--

Materials:	Terminal body: brass (CuZn39Pb2) bright Housing: PA 6 (Halogen-free) Screws: steel Zn thick-film passivated
------------	---

Flame resistance:	Self-extinguishing
-------------------	--------------------

Mechanical data:	Dimensions: width x height x depth (mm): 15,2 x 55,2 x 47,8
------------------	---

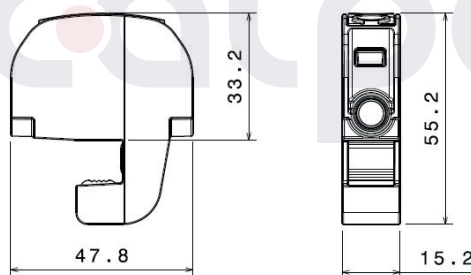

**Approved phase rails dimensions / Outgoing**

	busbar strength						
	3 mm	4 mm	5 mm		10 mm		
E-Cu, blank (width in mm)	-	12	12, 15, 20, 25, 30, 40, 50, 60, 63, 80, 100, 125		12, 15, 20, 30, 40, 50, 60, 80, 100, 120, 160, 200		
E-Cu, tin-plated (width in mm)	10	-	12, 15, 20, 25, 30		12, 20, 30, 40, 50, 60, 80, 100, 120		
Nominal current	76 A	76 A	114 A	76 A	114 A	76 A	114 A
Outgoings (maximum cross section)	1 x 16 mm <sup>2</sup>	1 x 16 mm <sup>2</sup>	2 x 10 mm <sup>2</sup>	1 x 16 mm <sup>2</sup>	2 x 10 mm <sup>2</sup>	1 x 16 mm	2 x 10 mm <sup>2</sup>

**Design**

Basic housing colour – light grey RAL 7035

Part no.	Design	Cover colour	PU	GTIN (EAN)
086105-0-4	Universal	light grey RAL 7035	12	4051589610506

## Technical data

Description:	Busbar Tapping 16mm <sup>2</sup>
Construction:	uninsulated
Item no. :	086105-9-2

Remarks:	The product is compliant with the EC ROHS directives
Standards:	-
Nominal Voltage:	690 V
Nominal current:	114 A - (Details see below)

### Busbar cross section / Incoming

1 x Busbar	Cu Stärke (Höhe) 3 – 10 mm / Tiefe (Breite) mindestens 10 mm
	Clamping screw for busbar connection:
	cross-head screw M8 x 20 +/- PZ3
	tightening torque 3 Nm

### Terminal cross section / Outgoing

2 x 16 mm <sup>2</sup>	1,5 – 16 mm <sup>2</sup> , round conductor Cu (solid wire and multi wire)
	1 – 10 mm <sup>2</sup> , stranded wire with ferrule
	cross-head screw M6 x 10 +/- PZ2
	tightening torque 2,5 Nm
	stripping length 9 mm

Materials:	Terminal body:	brass (CuZn39Pb2)	bright
	Screws:	steel	Zn thick-film passivated

Mechanical data:	Dimensions:	width x height x depth (mm):	12 x 37 - 42,1 x 32
------------------	-------------	------------------------------	---------------------

mounted dimensions (5 mm bar)

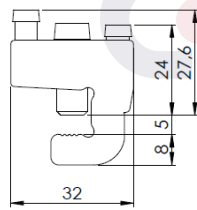

mounted dimensions (10 mm bar)

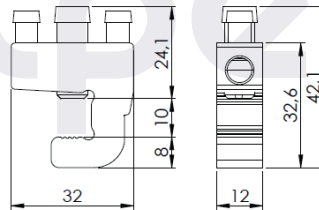

### Zugelassene Sammelschienenabmessungen / Abgänge

	busbar strength						
	3 mm	4 mm	5 mm		10 mm		
E-Cu, blank (width in mm)	-	12	12, 15, 20, 25, 30, 40, 50, 60, 63, 80, 100, 125		12, 15, 20, 30, 40, 50, 60, 80, 100, 120, 160, 200		
E-Cu, tin-plated (width in mm)	10	-	12, 15, 20, 25, 30		12, 20, 30, 40, 50, 60, 80, 100, 120		
Nominal current	76 A	76 A	114 A	76 A	114 A	76 A	114 A
Outgoings (maximum cross section)	1 x 16 mm <sup>2</sup>	1 x 16 mm <sup>2</sup>	2 x 10 mm <sup>2</sup>	1 x 16 mm <sup>2</sup>	2 x 10 mm <sup>2</sup>	1 x 16 mm	2 x 10 mm <sup>2</sup>

### Design

Basic housing colour – light grey RAL 7035

Part no.	Design	Cover colour	PU	GTIN (EAN)
086105-9-2	Universal	-	12	4051589610599