



BULLETS & RECEPTACLES (PC · PCE TYPE)

SPECIFICATION

■ MATERIAL : Terminal : Brass (Electro-tin-plated)
Sleeve : Oxygen free copper tube
(electro-tin-plated)

Insulator: Nylon

■ RATED VOLTAGE : 300V

■ RATED CURRENT : See following table

Wire mm ²	0.5	0.75	1.25	2
A	10	12	15	20

■ INSULATOR TEMPERATURE : - 40°C ~ + 105°C

■ FLAME RETARDANCE : UL94V2

■ APPLICABLE WIRE : Performance ratings comply with JIS standards wire(IV · KIV · VSF)

PC TYPE

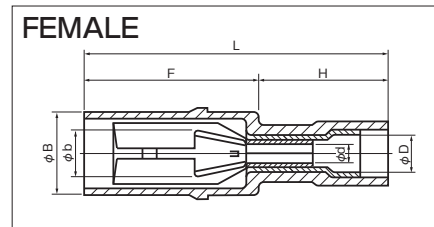
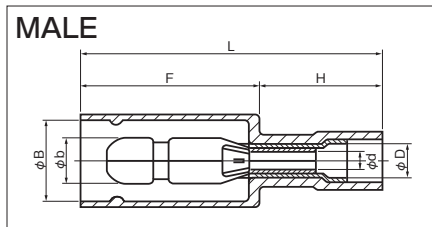
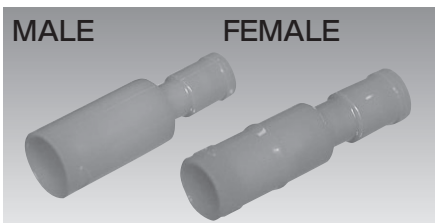

PART NUMBER	DIMENSIONS mm							WIRE RANGE		TOOL No.		INS	STD COLOR	STD QTY/BOX	
	φb	φB	φd	φD	L	F	H	STRANDED mm ²	AWG	HAND TOOL No.	HAND TOOL No.				
PC 2005-M	2.0	5.1	1.7	3.1	26.5	15.0	11.5	0.5 0.75	20-18	NH 5 NH 32 NA 10 NA 3	N10 10 N3 5	Nylon	TRANSLUCENT	1,000 (100×10)	
PC 2005-F	2.0	4.7			24.5	13.0									
PC 4009-M	4.0	7.4	1.8	3.2	27.7	16.5	0.75 1.25	18-16	NH 11 NH 32 NA 10 NA 3	N10 11 N3 11	RED				1,000 (100×10)
PC 4009-F	3.9	6.9			26.2	15.0									
PC 4020-M	4.0	7.4	2.4	3.9	27.7	16.5	2.0	14	NH 12 NH 32 NA 10 NA 3	N10 12 N3 12					
PC 4020-F	3.9	6.9			26.2	15.0									

No insulator lock on PC2005.

PCE TYPE

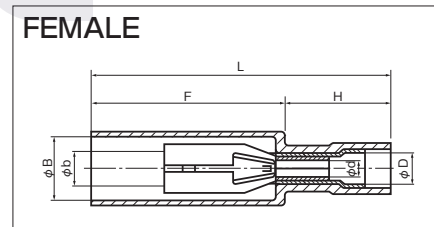
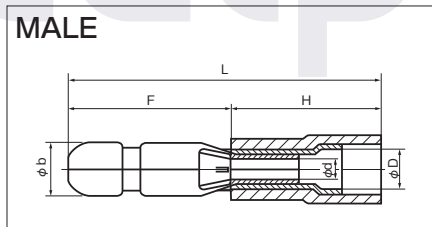
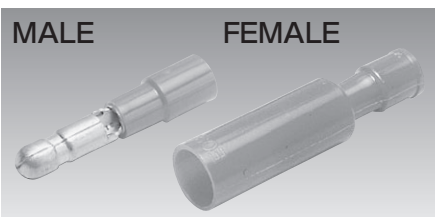

PART NUMBER	DIMENSIONS mm							WIRE RANGE		TOOL No.		INS	STD COLOR	STD QTY/BOX		
	φb	φB	φd	φD	L	F	H	STRANDED mm ²	AWG	HAND TOOL No.	HAND TOOL No.					
PCE 4009-M	4.0	—	1.8	3.2	25.2	13.0	12.2	0.75 1.25	18-16	NH 11 NH 32 NA 10 NA 3	N10 11 N3 11	Nylon	RED	1,000 (100×10)		
PCE 4009-F	3.9	6.5			31.5	20.3	11.2									
PCE 4020-M	4.0	—	2.4	3.9	25.2	13.0	12.2	2.0	14	NH 12 NH 32	N10 12 N3 12				BLUE	500 (100×5)
PCE 4020-F	3.9	6.5			31.5	20.3	11.2									
PCE 5020-M	5.0	—	2.4	3.9	25.2	13.0	12.2	2.0	14	NA 10 NA 3	N10 12 N3 12					
PCE 5020-F	4.9	7.4			31.5	20.3	11.2									

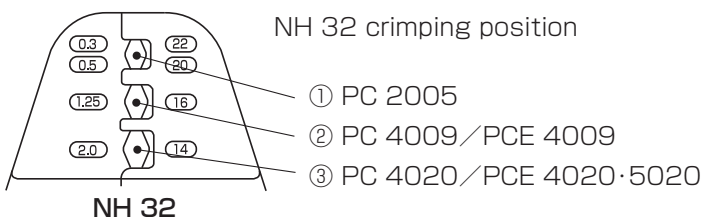



INSULATED BULLETS & RECEPTACLES • BUTTS, WP-TYPE

No heat required.

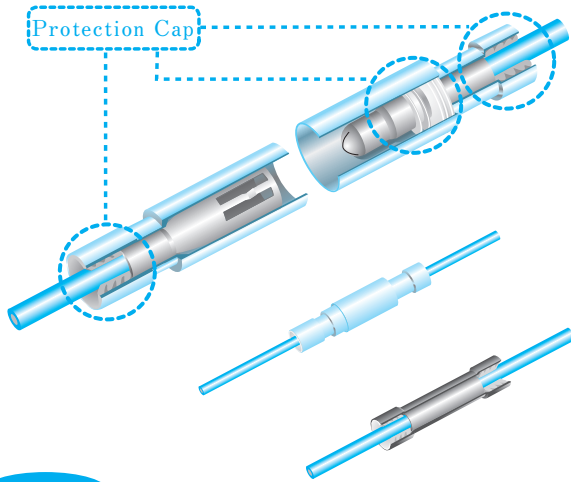

SPECIFICATION

■ RATED VOLTAGE 300V

■ RATED CURRENT

WIRE SIZE	PC	TMNB
1.25mm ²	15A	19A
2mm ²	20A	27A

■ FLAME RETARDANCE UL94V-2

■ INSULATOR TEMPERATURE - 40°C ~ + 105°C

■ PROTECTION IP57 (IEC529)

RoHS10

See page 2

INSULATED BULLETS/RECEPTACLES, WP-TYPE

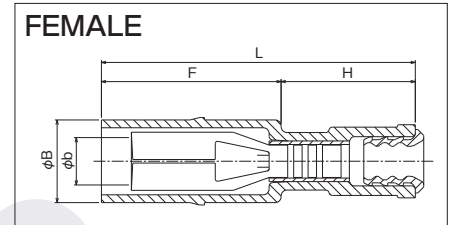
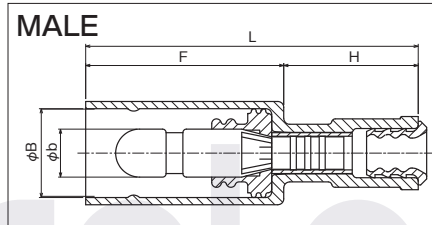
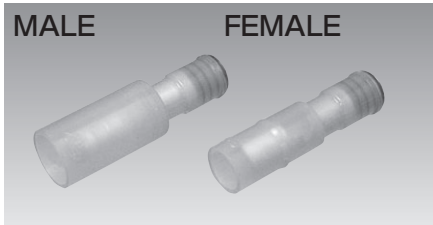

PART NUMBER	DIMENSIONS mm					WIRE RANGE			TOOL No.	INS	STD COLOR	STD QTY/BOX
	φb	φB	L	F	H	STRANDED mm ²	AWG	WIRE OUTSIDE DIAMETER				
PC 4009-M-WP	4.0	7.4	27.7	16.5	11.2	0.75	18-16	φ2.6	NH 64	Nylon	RED TRANSLUCENT	1,000 (100×10)
PC 4009-F-WP	3.9	6.9	26.2	15.0		1.25		φ3.2				
PC 4020-M-WP	4.0	7.4	27.7	16.5		2.0	14	φ3.0				
PC 4020-F-WP	3.9	6.9	26.2	15.0				φ3.6				

INSULATED BUTT CONNECTORS, WP-TYPE

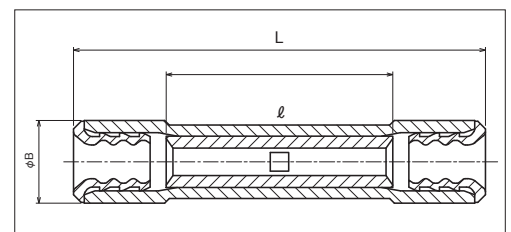

RoHS10

See page 2

PART NUMBER	DIMENSIONS mm			WIRE RANGE			TOOL No.	INS	STD COLOR	STD QTY/BOX
	L	φB	ℓ	STRANDED mm ²	AWG	WIRE OUTSIDE DIAMETER				
TMN B-1.25-WP	26.9	5.4	15.0	0.5 ~ 1.25	20-16	φ2.5 ~ φ2.9	NH 64	Nylon	RED TRANSLUCENT	1,000 (100×10)
TMN B-2-WP		6.1		1.04 ~ 2.63	16-14	φ3.0 ~ φ3.6				