

ENVIRONMENTALLY FRIENDLY INSULATED TERMINALS (TC TYPE)

■ TMEX TC TYPE

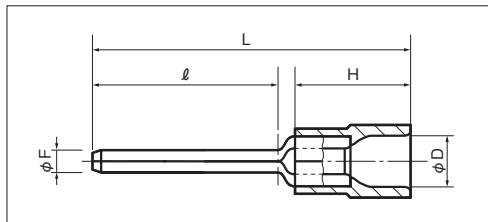

RoHS10

See page 2

B

PART NUMBER	DIMENSIONS mm					WIRE RANGE		TOOL No.		STD COLOR	STD QTY/BOX	
	φF	l	L	H	φD	STRANDED mm ²	AWG	HAND TOOL No.	DIES No.			
TMEX TC-0.3-9.5 ○	1.0	9.5	20.8	10.0	2.8	0.2-0.5	24-20	NH 5 NH 32 NH 60	NA 10 NA 3	N10 10 N3 5	YELLOW	1,000 (100×10)
TMEX TC-1.25-11 ○	1.9	11.0	23.0	10.0	4.1	0.3 ∩ 1.65	22-16	NH 11 NH 32	NA 10 NA 3	N10 11 N3 11	RED	1,000 (100×10)
TMEX TC-1.25-11S ○	1.5											
TMEX TC-1.25-16 ○	1.9											
TMEX TC-1.25-16S ○	1.5											
TMEX TC-1.25-20 ○	1.9											
TMEX TC-1.25-20S ○	1.5											
TMEX TC-2-11 ○	1.9	11.0	23.0	10.0	4.5	1.04 ∩ 2.63	16-14	NH 12 NH 32	NA 10 NA 3	N10 12 N3 12	BLUE	1,000 (100×10)
TMEX TC-2-11S ○	1.5											
TMEX TC-2-16 ○	1.9											
TMEX TC-2-16S ○	1.5											
TMEX TC-2-20 ○	1.9											
TMEX TC-2-20S ○	1.5											
TMEX TC-5.5-11 ○	2.7	11.0	28.5	14.0	6.8	2.63 ∩ 6.64	12-10	NH 13	NA 10 NA 3	N10 13 N3 13	YELLOW	50

NOTE 1) ○ : UL · C-UL

NOTE 2) Please refer to page 41 for proper strip length of wire.